

## 923 Utility Adjustments

### 923.1 General

Utility Adjustments sheets provide a plan view that highlights the location of existing, proposed, and relocated utilities. These sheets are used when the project corridor contains numerous utilities with significant potential for conflict or harm. Projects with minor utility work or impacts may include this information on roadway (or other component) plan sheets.

#### 923.1.1 Utility Notes

See **FDM 914** for required utility notes to be included on the General Notes sheet.

### 923.2 Required Information

The Utility Adjustments sheets are typically developed from the CADD files for the Roadway Plan-Profile sheets (showing only the plan portion). Display a north arrow and scale within each plan view, typically in the upper right portion.

Display the roadway plan view (gray-scaled as background) such that the centerline of construction or baseline of construction stationing increases from left to right. Other proposed design elements should also be shown, such as overhead signs and mast arms. Do not display information and graphic data that is not relevant.

Display and label the following information:

- (1) Display existing and proposed utilities within the project limits using lines and standard utility symbols (see the [CADD Manual](#)). Though not utilities, display and label Department-owned subsurface communication (ITS) lines.
- (2) Indicate the disposition of existing utilities which are not to remain in service (e.g., "To Be Removed", "To Be Adjusted", "To Be Relocated", "To Be Placed Out Of Service").
- (3) Indicate the utility type, Agency Owner (UAO), and size and material of existing utilities which are to remain in service.
- (4) Display and label overhead utilities indicating the line voltage. For a multi-line electrical overhead crossing, accurately show the location of each line.

- (5) Indicate the field-verified vertical elevation and horizontal location ( $V_{vh}$ ) of existing utilities (SUE data). A leader line must point to the location in plan view where the field data was taken. Include the  $V_{vh}$  number shown in the Utility Verification table.
- (6) Display a Utility Verification table in each view panel of the sheet that contains  $V_{vh}$  information for utilities shown in that panel. Required table information includes:
  - (a)  $V_{vh}$  number
  - (b) Utility type and owner
  - (c) Size and material
  - (d) Location (Sta/Offset/Lt or Rt)
  - (e) Existing ground and top of utility elevations

If the number of  $V_{vh}$  data points or required view panels are extensive, the table may be shown on separate sheets titled Utility Verification Sheets.

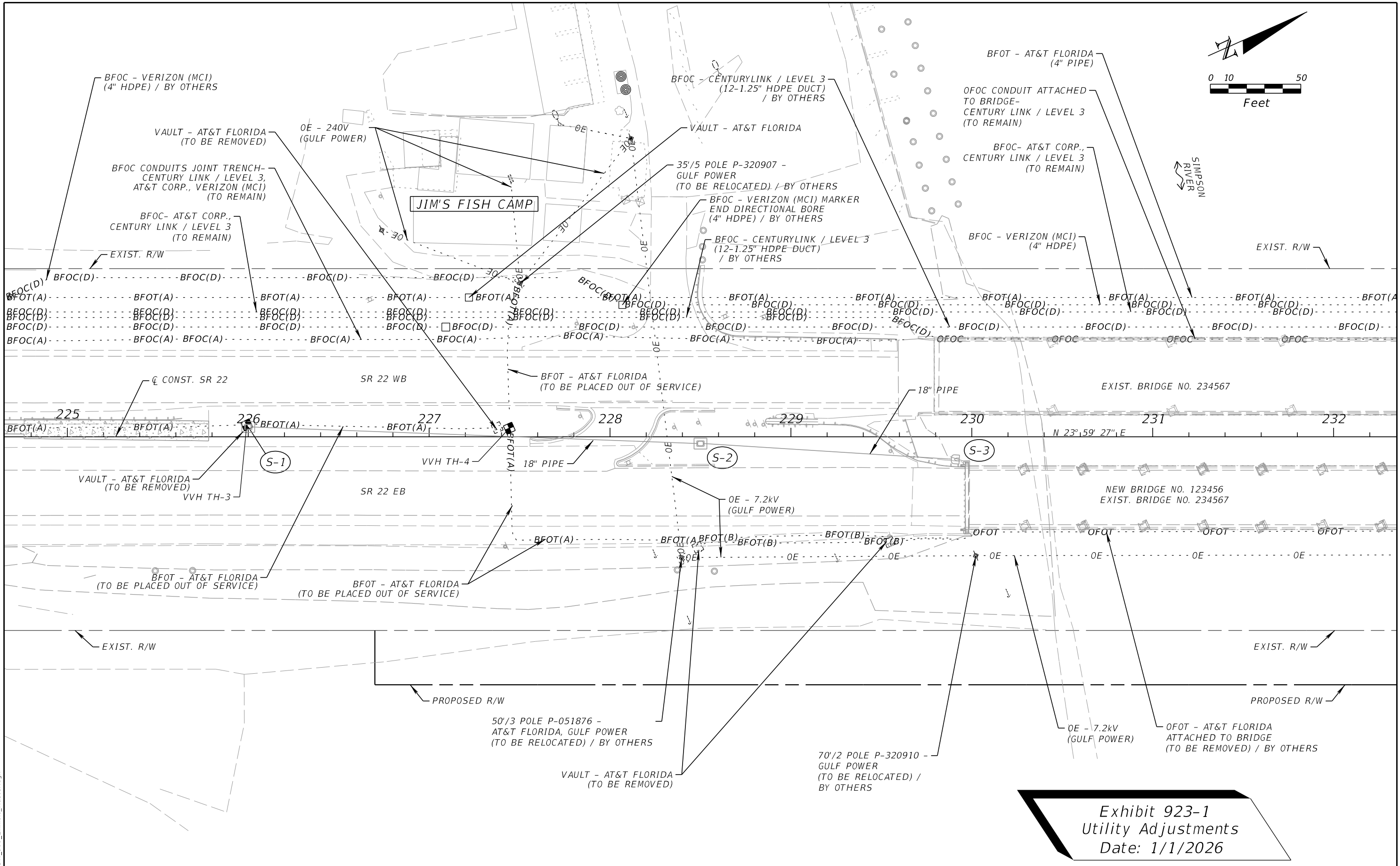
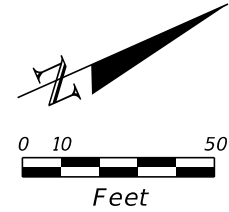

**Exhibit 923-1**  
**Utility Adjustments**  
 Date: 1/1/2026

10/28/2025 10:04:58 AM KNASDMS C:\CADD\_Docs\FIN\FDM\_900\_Exhibit\_Master.dgn

REVISIONS				ENGINEER OF RECORD		STATE OF FLORIDA DEPARTMENT OF TRANSPORTATION			SHEET NO.
DATE	DESCRIPTION	DATE	DESCRIPTION	LUKE S. WALKER, P.E. LICENSE NUMBER: 12345 ROADWAY ENGINEERS, INC. 123 MAIN STREET TALLAHASSEE, FL 32301		ROAD NO.	COUNTY	FINANCIAL PROJECT ID	
								SR 22	BAY

THE OFFICIAL RECORD OF THIS SHEET IS THE ELECTRONIC FILE DIGITALLY SIGNED AND SEALED UNDER RULE 61G15-23.004, F.A.C.